

FATHOUSE PERFORMANCE

Fathouse Performance 2020+ GT500 Billet Deep Sump Trans Pan Installation Guide



Fathouse Performance 2020+ GT500 Billet Deep Sump Trans Pan Installation Guide

Removal

1. With the vehicle in NEUTRAL, position it on a hoist.
2. Disconnect the battery.

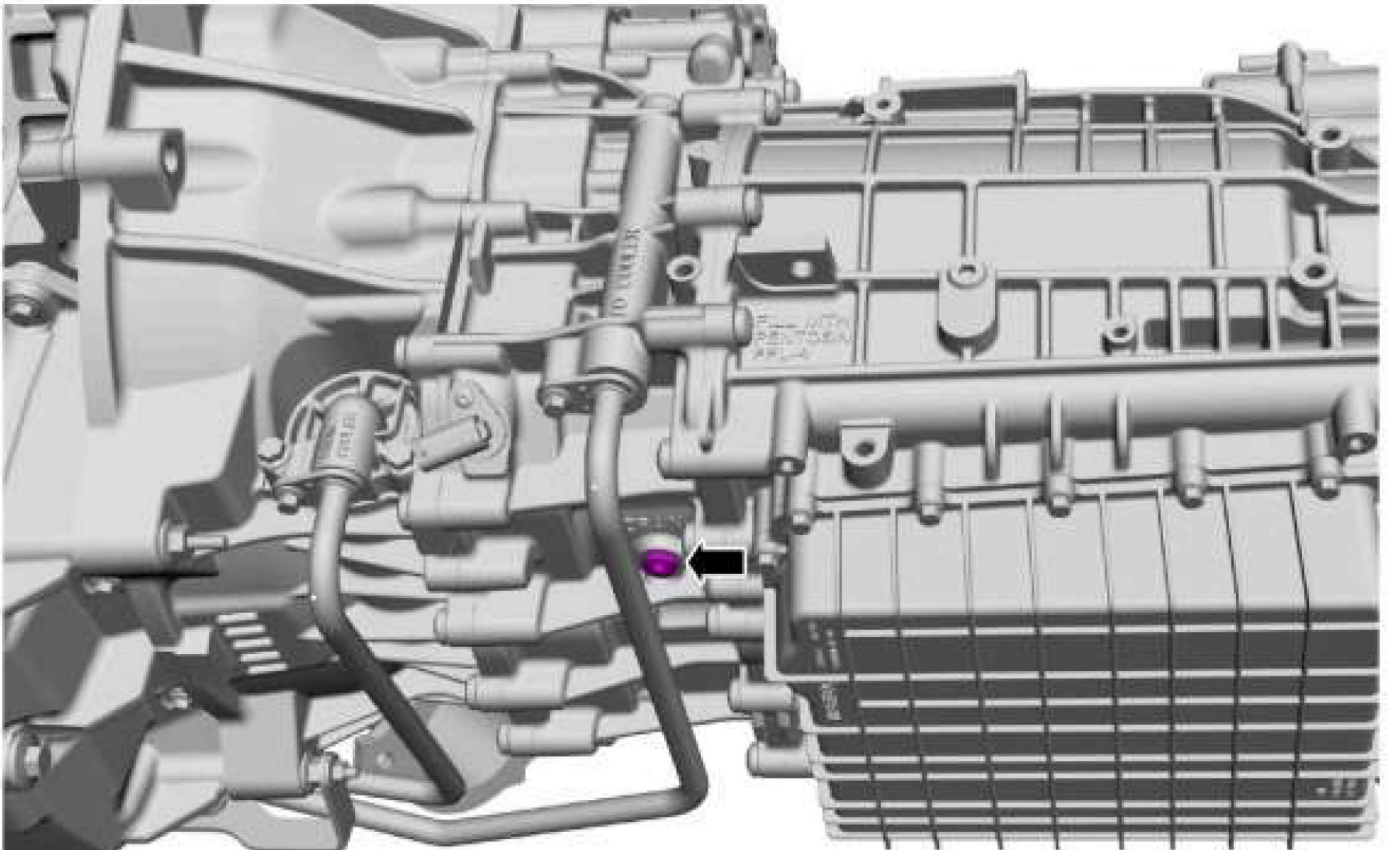

3. Remove the drain plug and drain the transmission fluid. Re-install the drain plug.
Torque: 150 lb.in (17 Nm)

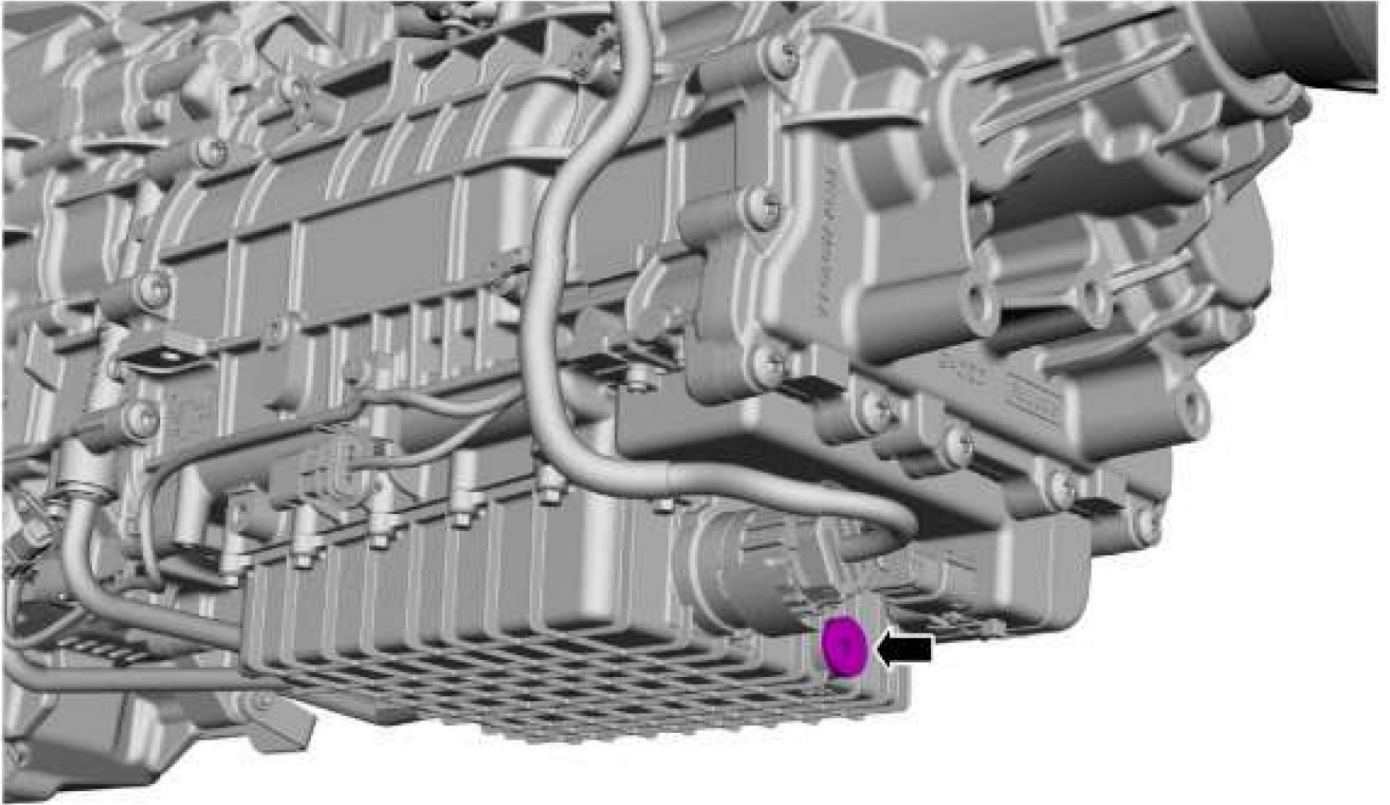
Fathouse Performance 2020+ GT500 Billet Deep Sump Trans Pan Installation Guide

4. Remove the fluid pan drain plug and drain the transmission fluid. Re-install drain plug.

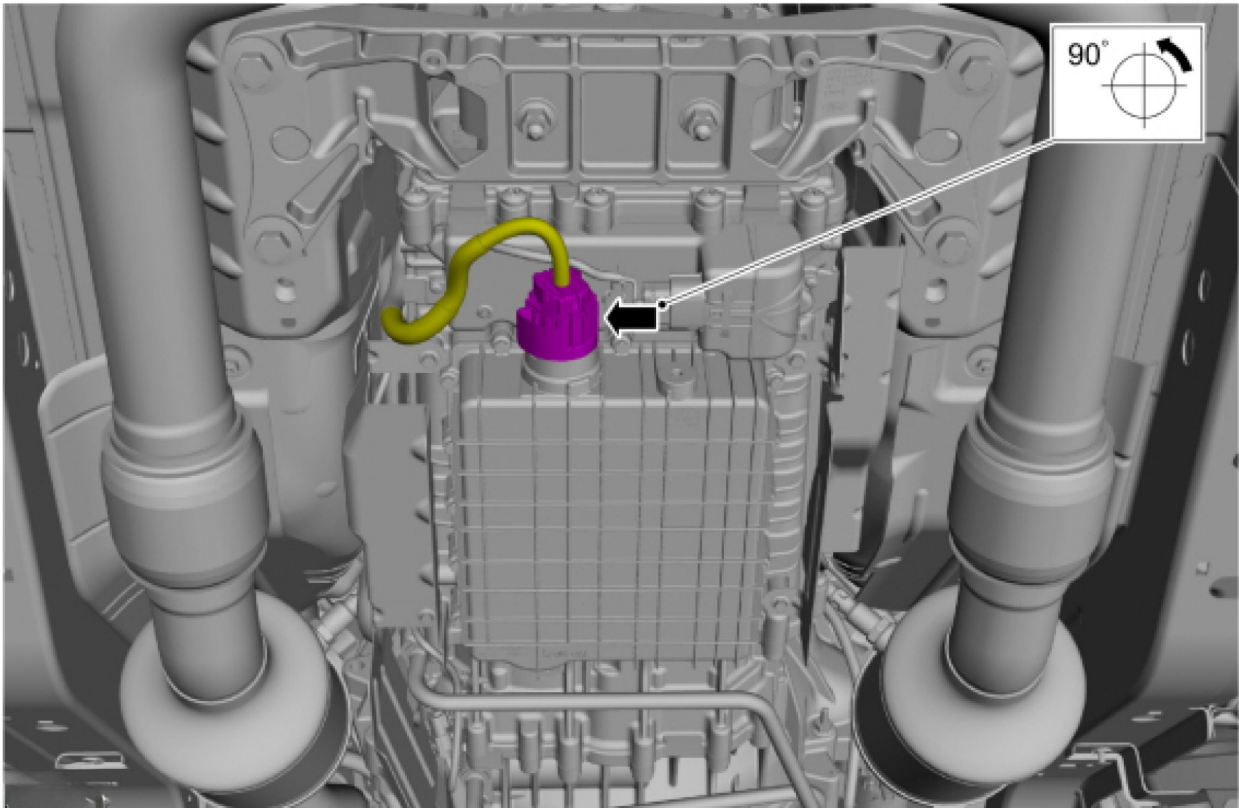
Fathouse Performance 2020+ GT500 Billet Deep Sump Trans Pan Installation Guide

5. Disconnect the bulkhead electrical connector by rotating the electrical connector 90 degrees counter clockwise.

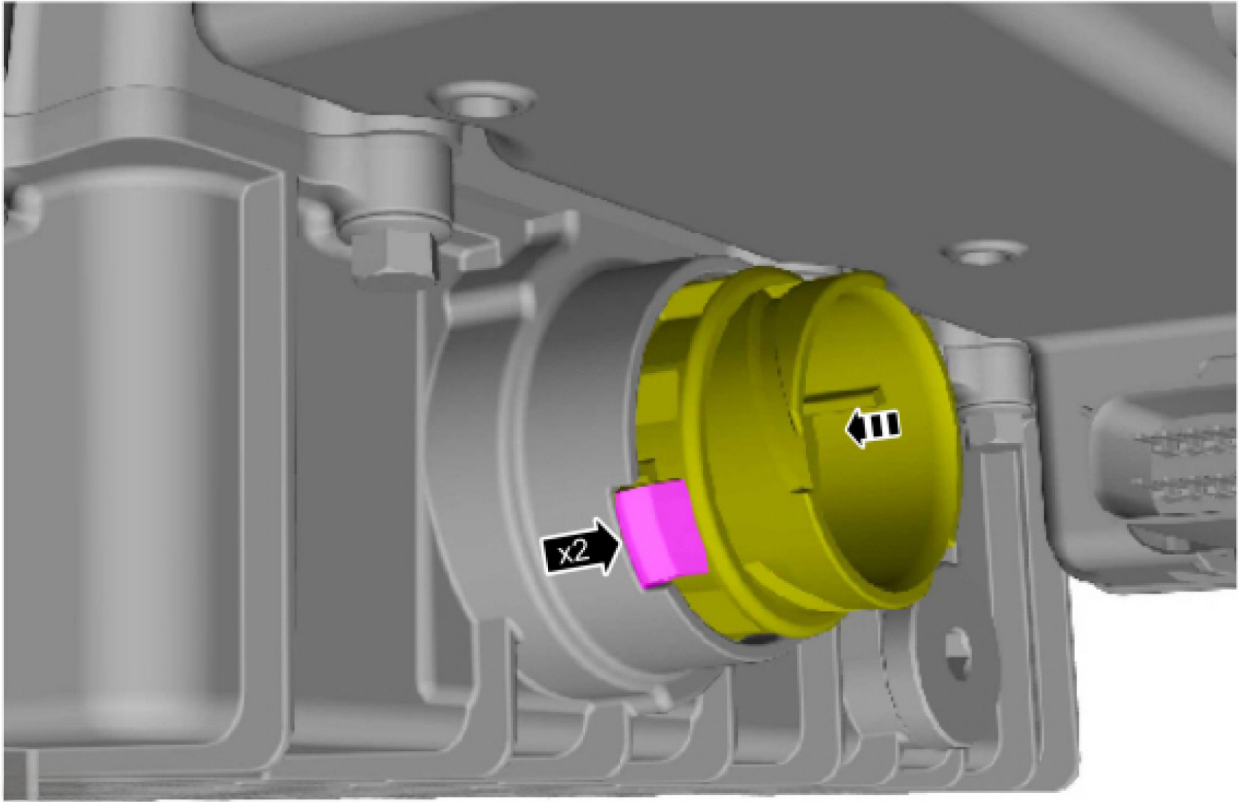
Fathouse Performance 2020+ GT500 Billet Deep Sump Trans Pan Installation Guide

6. Push the bulkhead locks in and push the bulkhead connector into the transmission fluid pan.

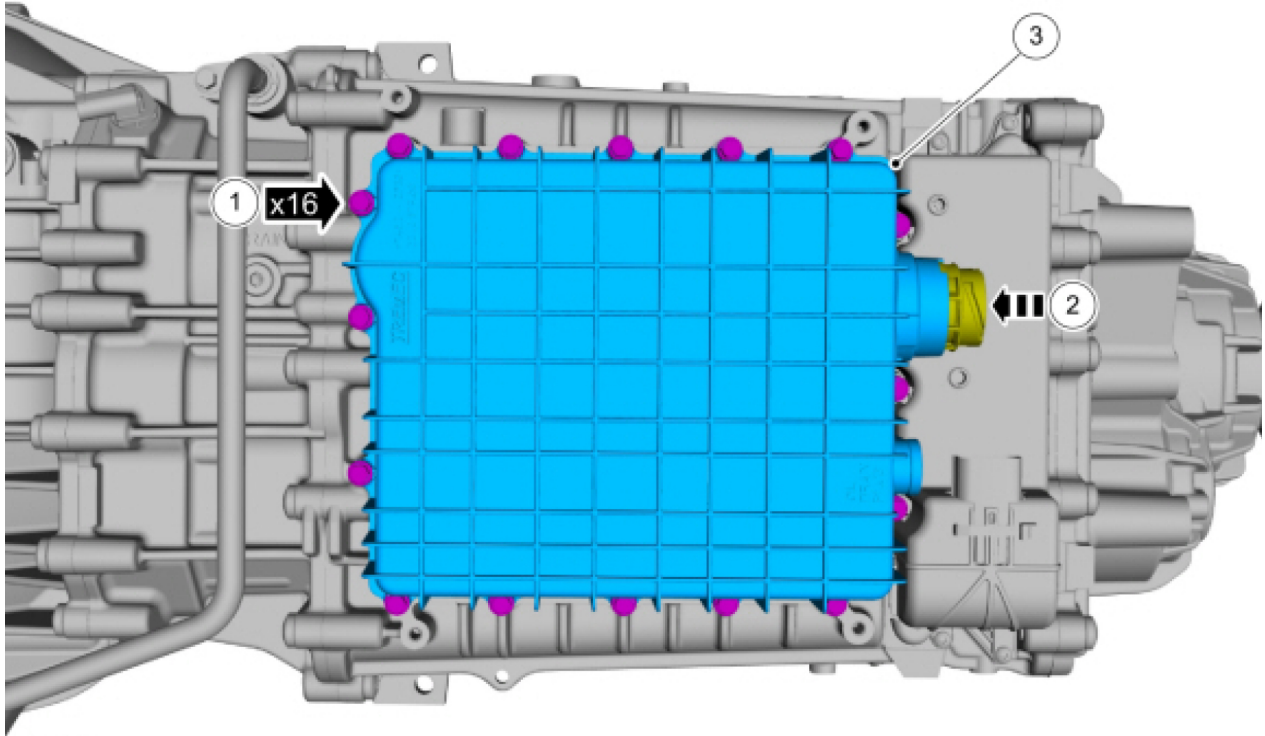
Fathouse Performance 2020+ GT500 Billet Deep Sump Trans Pan Installation Guide

7. Remove the transmission fluid pan.
 1. Remove the transmission fluid pan bolts.
 2. Push the bulkhead electrical connector through the transmission pan.
 3. Remove the transmission fluid pan.

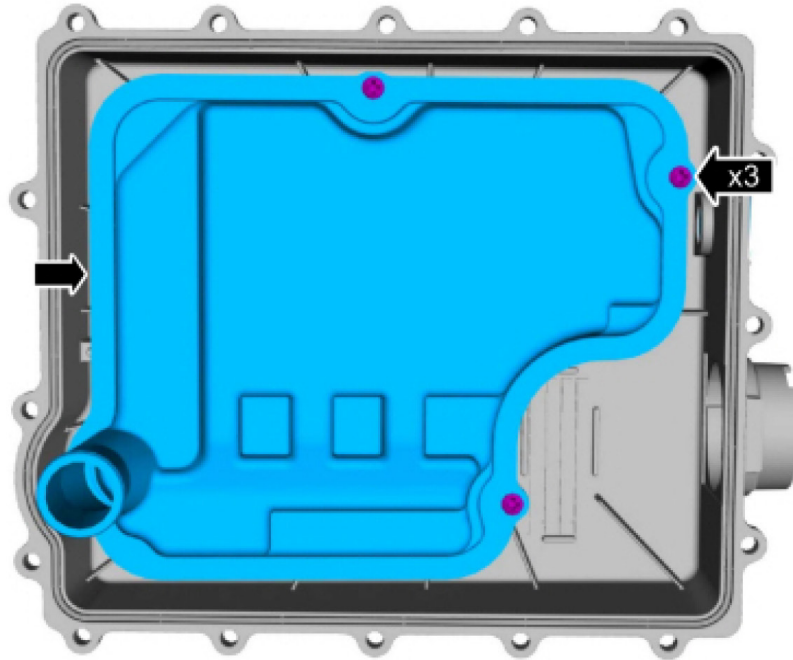
Fathouse Performance 2020+ GT500 Billet Deep Sump Trans Pan Installation Guide

8. NOTE: The transmission fluid filter may be reused if no excessive contamination is indicated. Remove the screws and the transmission fluid filter.

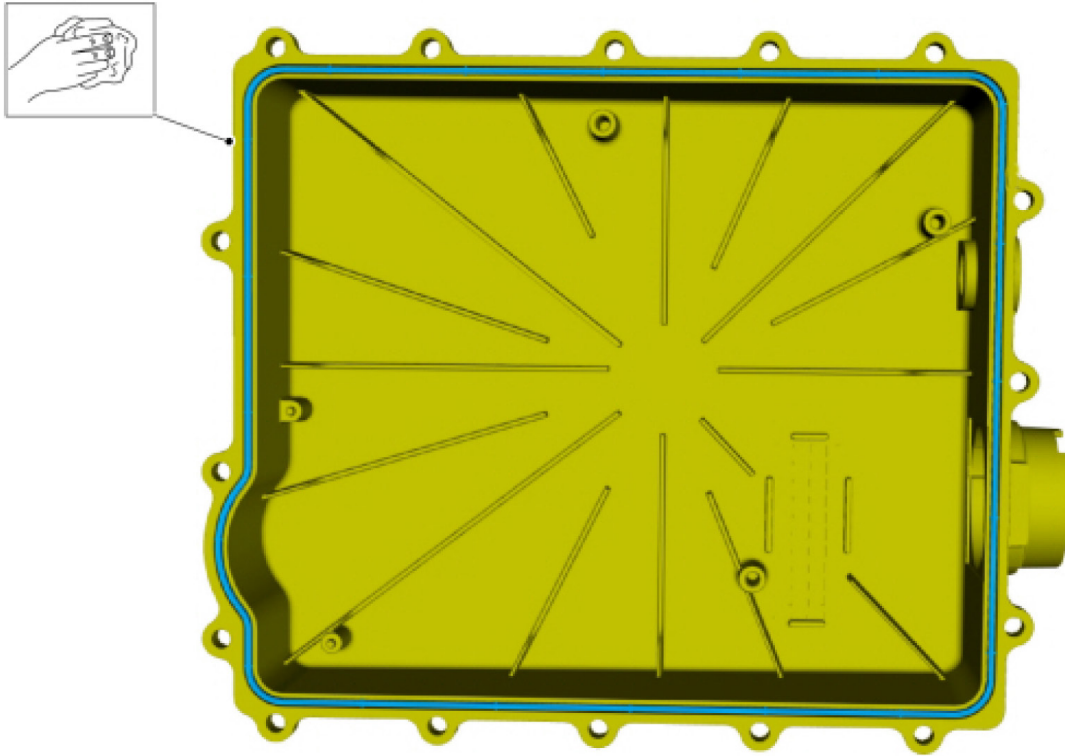
Fathouse Performance 2020+ GT500 Billet Deep Sump Trans Pan Installation Guide

9. Remove the transmission seal. Inspect the seal for any tears. If seal is damaged it CANNOT be used on the new billet pan. Replace with P/N KR3Z-7D302-B.

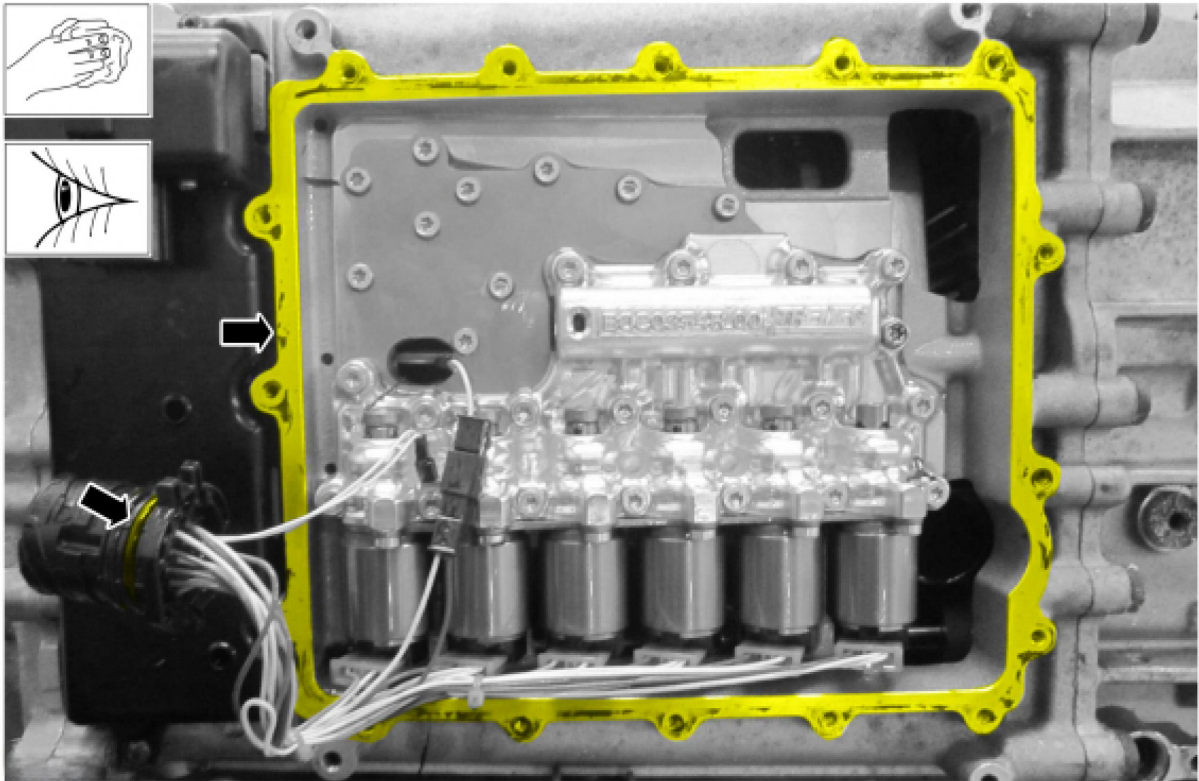
Fathouse Performance 2020+ GT500 Billet Deep Sump Trans Pan Installation Guide

10. Clean and inspect the transmission oil pan seal surface and the bulkhead electrical connector O-ring.

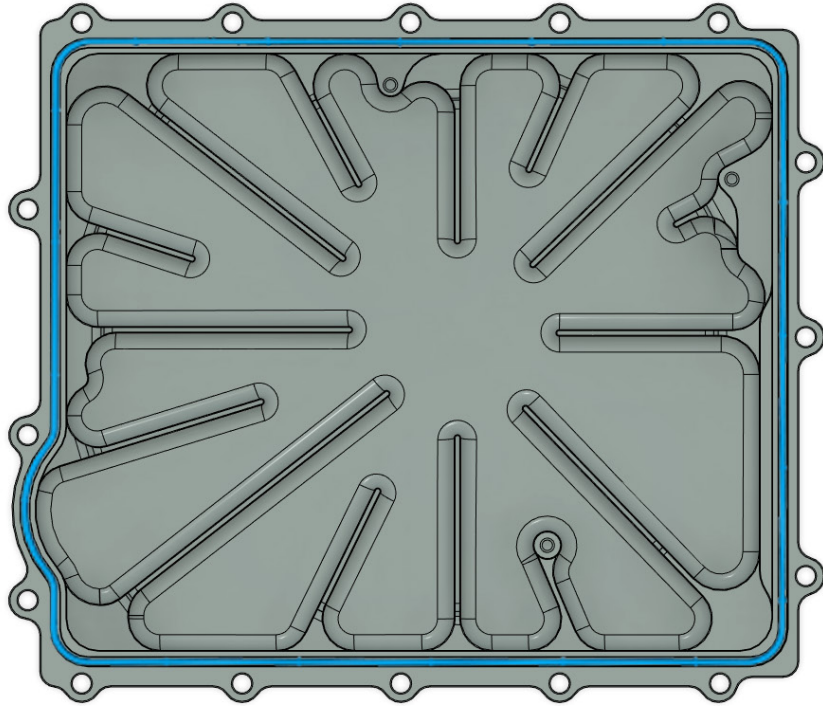
Fathouse Performance 2020+ GT500 Billet Deep Sump Trans Pan Installation Guide

11. Install OEM transmission pan seal on the billet transmission pan.

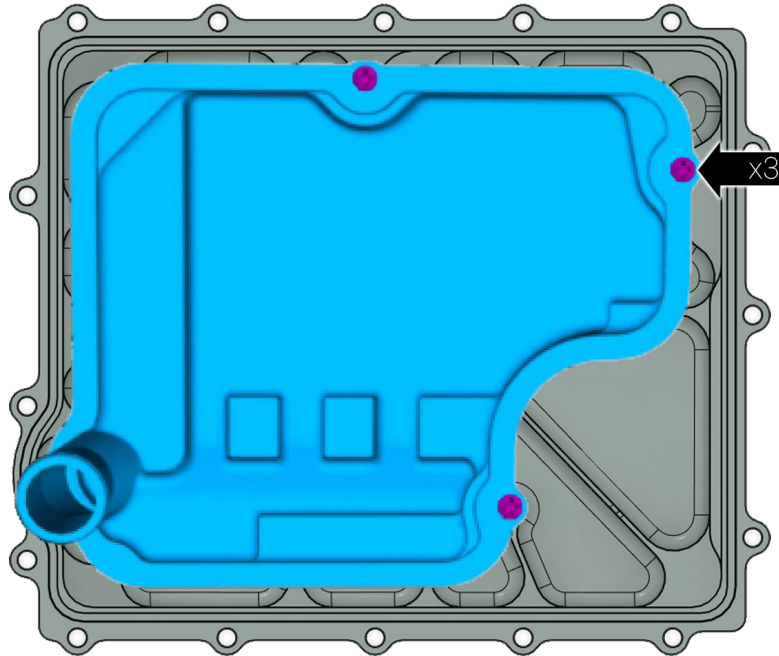
Fathouse Performance 2020+ GT500 Billet Deep Sump Trans Pan Installation Guide

12. Install the OEM transmission fluid filter and (3) new provided screws into the billet transmission pan. Torque: 12 lb.in (1.36 Nm)

Fathouse Performance 2020+ GT500 Billet Deep Sump Trans Pan Installation Guide

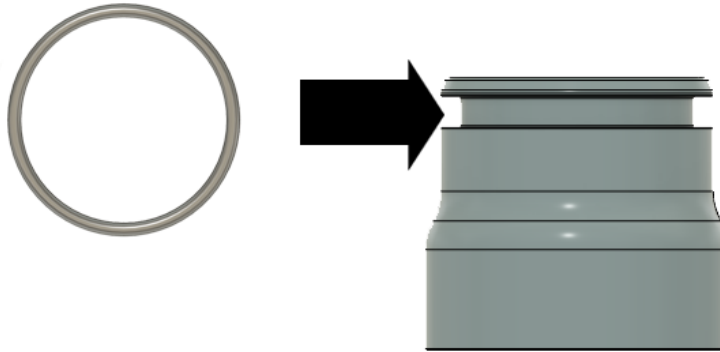

13. Install supplied o-ring onto the transmission pick up tube extension.

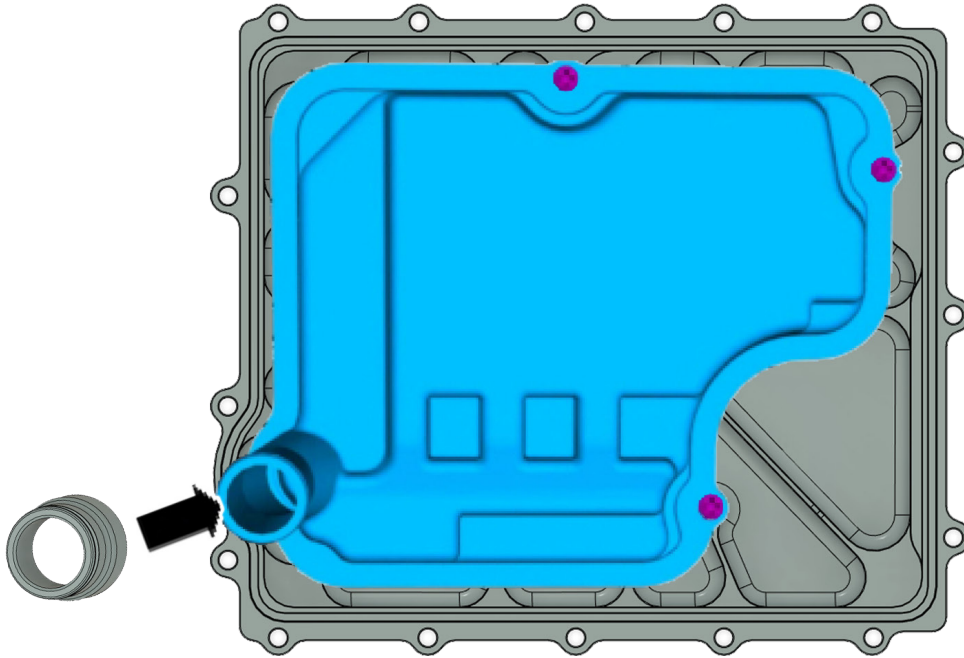
Fathouse Performance 2020+ GT500 Billet Deep Sump Trans Pan Installation Guide

14. Lube o-ring and install the pick up tube extension onto the transmission pick up tube as shown.

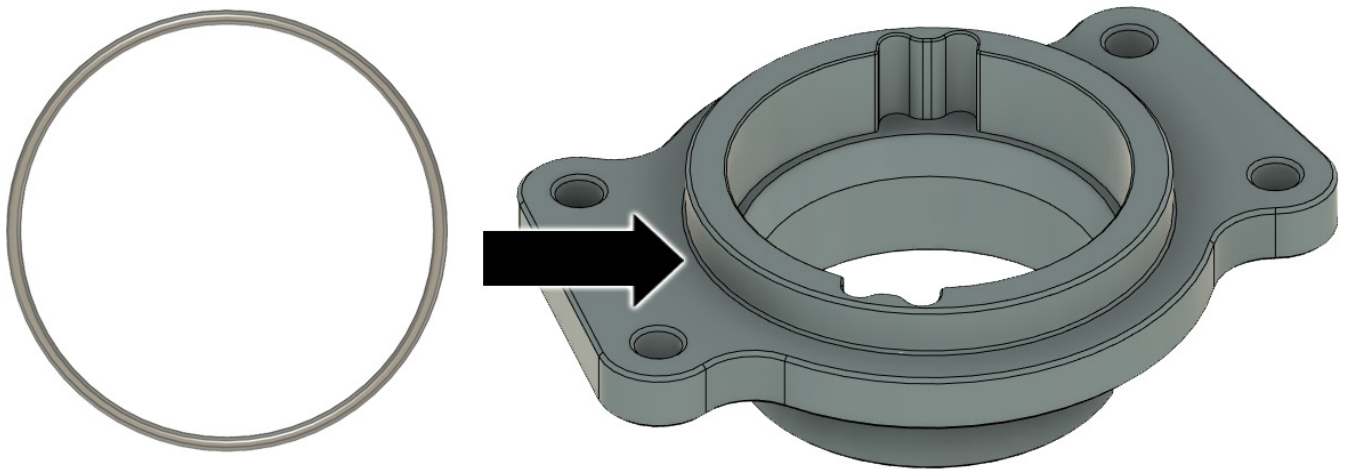
Fathouse Performance 2020+ GT500 Billet Deep Sump Trans Pan Installation Guide

15. Install provided o-ring onto the bulkhead electrical connector adapter flange as shown. Lube o-ring.

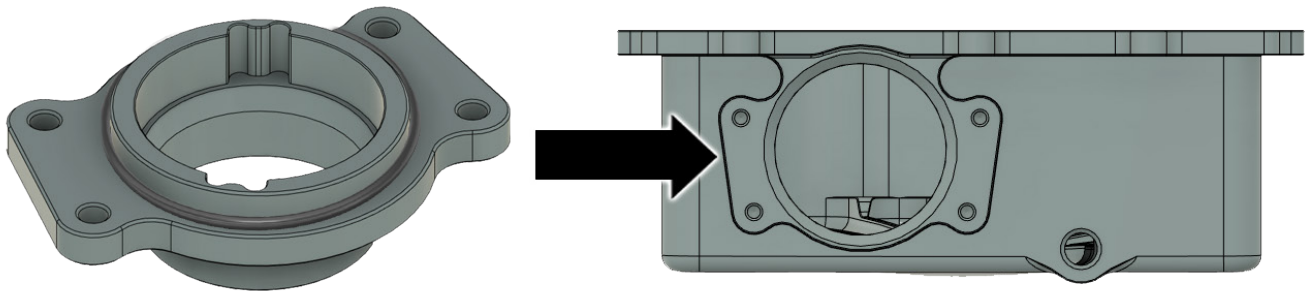
Fathouse Performance 2020+ GT500 Billet Deep Sump Trans Pan Installation Guide

16. Install bulkhead connector adapter flange onto the billet transmission pan using the (4) counter sunk screws provided. Place a dab of blue Loctite on the threads and torque to 71 in lbs. (8 Nm).

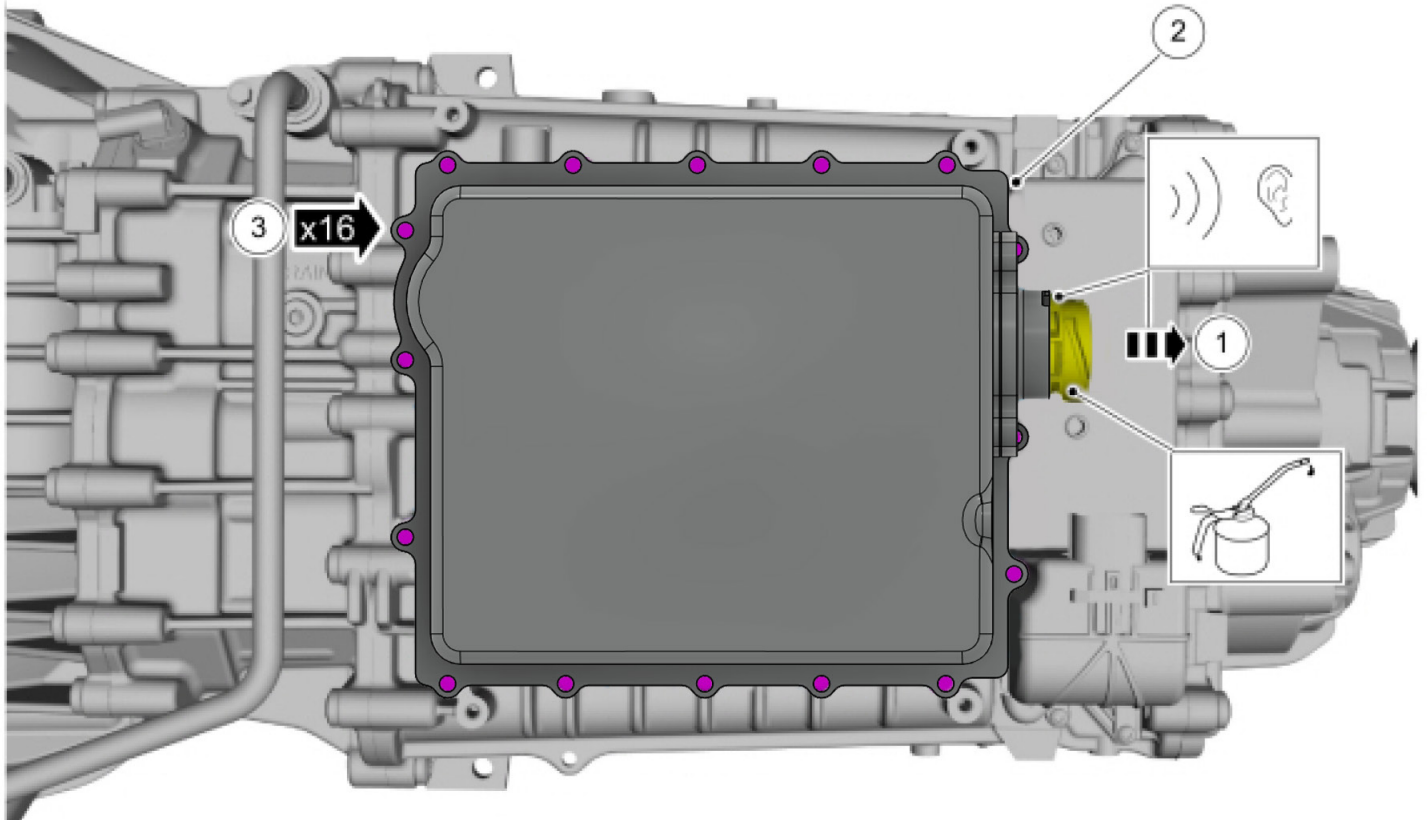
Fathouse Performance 2020+ GT500 Billet Deep Sump Trans Pan Installation Guide

17. Install billet transmission pan to TR-9070 transmission.

1. Lube and install the bulkhead electrical connector by pushing it through the transmission pan. Listen for the connector to snap in to locked position.
2. Install the transmission fluid pan.
3. Install the transmission fluid pan bolts.

Torque: 71 lb.in (8 Nm)

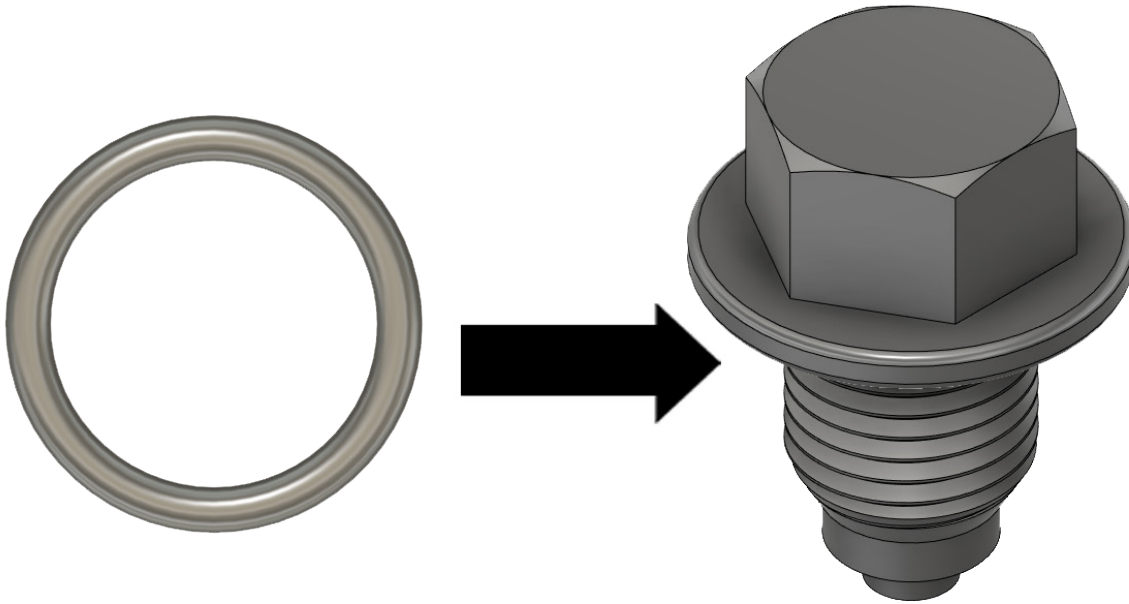
Fathouse Performance 2020+ GT500 Billet Deep Sump Trans Pan Installation Guide

18. Install provided o-ring onto the supplied drain plug. Lube o-ring.

Fathouse Performance 2020+ GT500 Billet Deep Sump Trans Pan Installation Guide

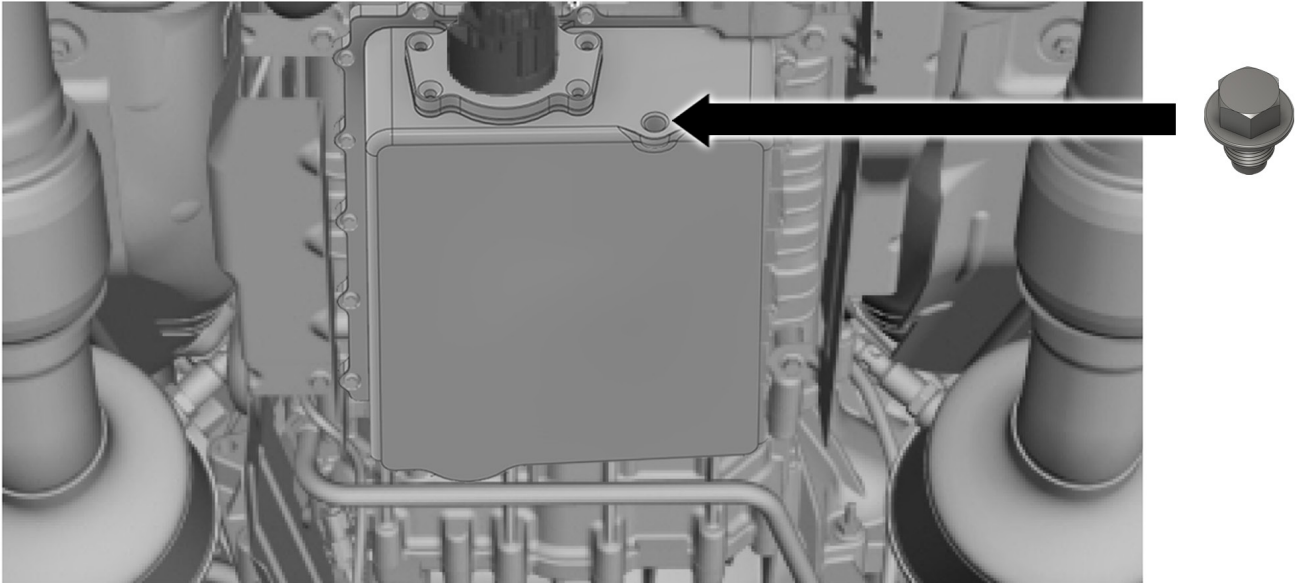

19. Install drain plug into billet transmission pan as shown. Torque: 53 in.lb (6 Nm)

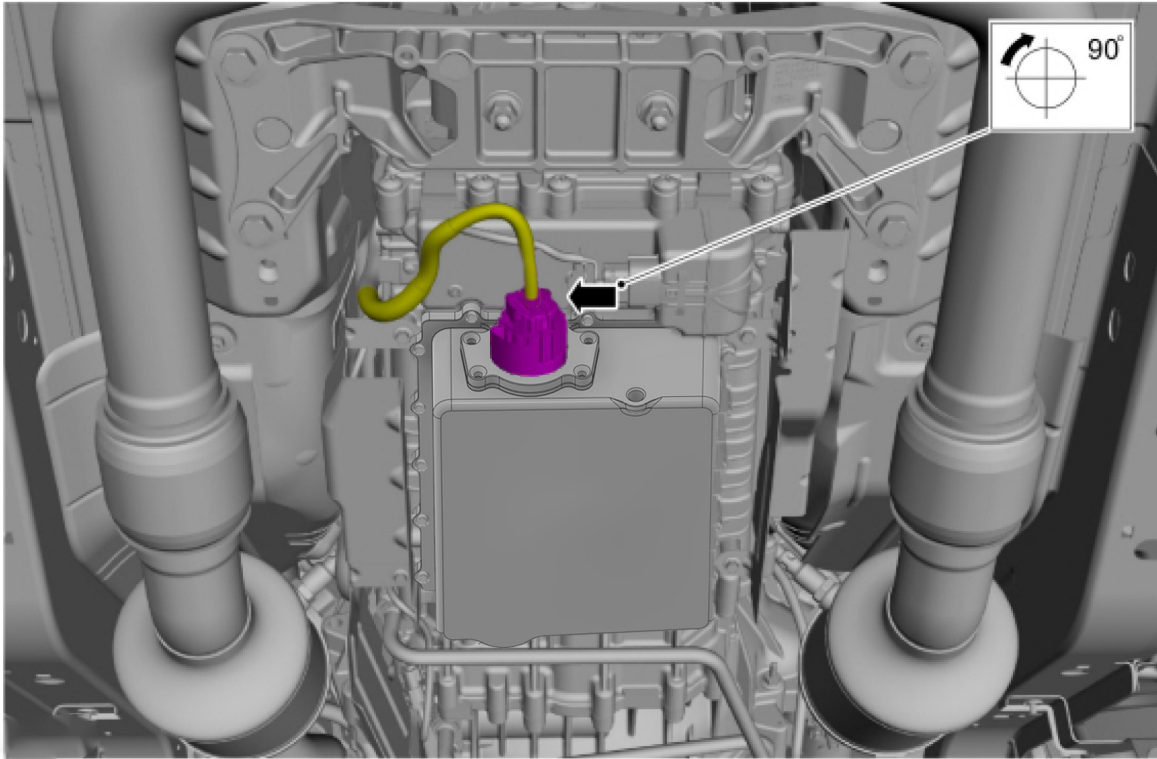
Fathouse Performance 2020+ GT500 Billet Deep Sump Trans Pan Installation Guide

19. Connect the bulkhead electrical connector. Secure the connector by rotating the connector clockwise until it locks in place.

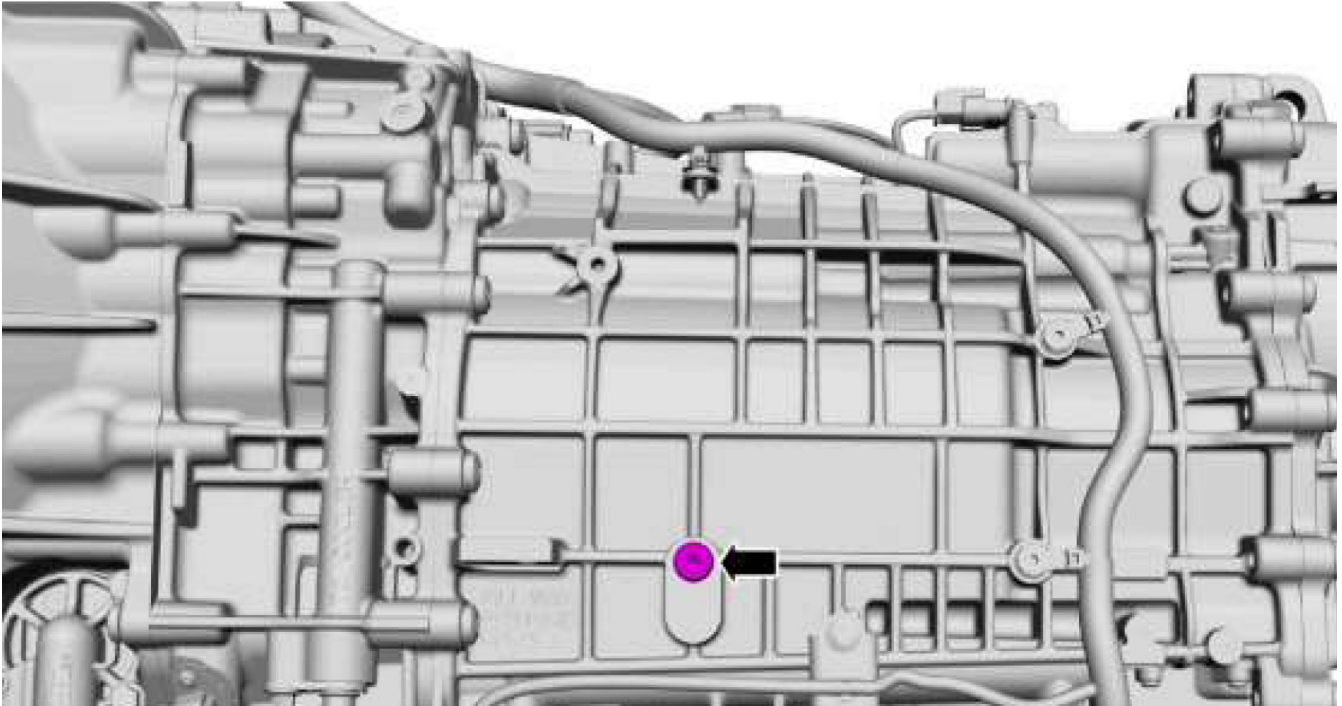
Fathouse Performance 2020+ GT500 Billet Deep Sump Trans Pan Installation Guide

21. NOTE: Make sure that the vehicle is level and remove the transmission fluid fill plug.

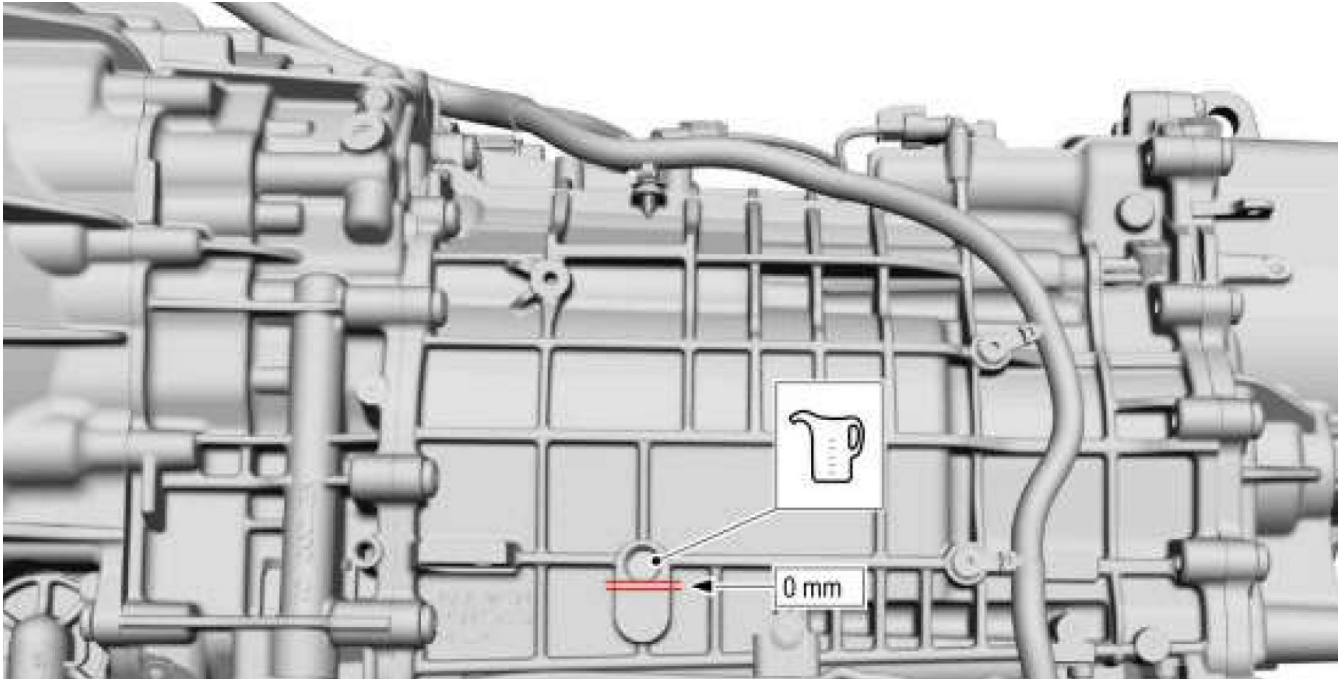
Fathouse Performance 2020+ GT500 Billet Deep Sump Trans Pan Installation Guide

22. Using the fluid dispenser, add the transmission fluid through the transmission fluid fill hole. Fill the transmission until the fluid is level with the fill hole.

Use Motorcraft® GT500 Dual Clutch Transmission Fluid/ XT-14-L

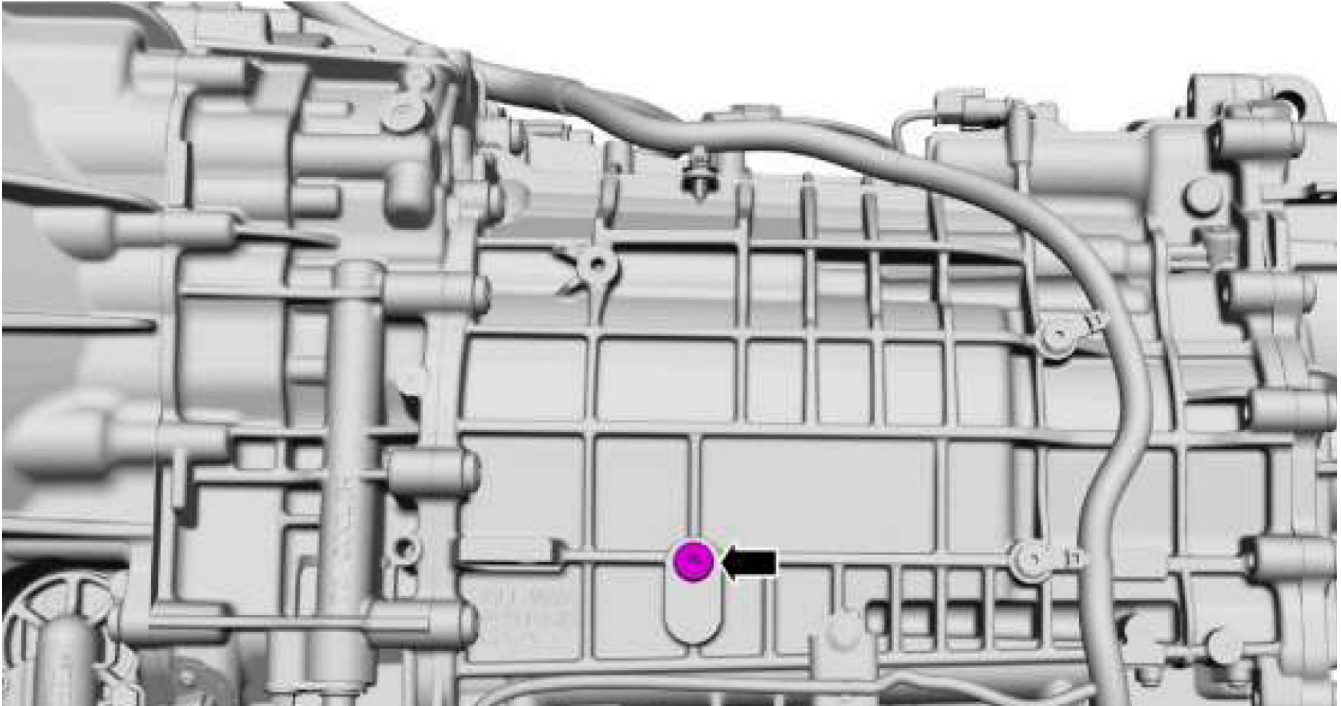
Fathouse Performance 2020+ GT500 Billet Deep Sump Trans Pan Installation Guide

23. Install the transmission fluid fill plug. Torque: 133 lb.in (15 Nm)
24. Reconnect battery.
25. Start vehicle and let engine run for 5-10 minutes. Turn off engine.
26. Note: Make sure vehicle is level.
27. Remove transmission fluid plug shown.
28. Using the fluid dispenser, add the transmission fluid through the transmission fluid fill hole. Fill the transmission until the fluid is level with the fill hole. Total fluid capacity should be 9 quarts.

Use Motorcraft® GT500 Dual Clutch Transmission Fluid/ XT-14-L

29. Install the transmission fluid fill plug. Torque: 133 lb.in (15 Nm)